

Master Cylinder

CLUTCH SYSTEM

6. Master Cylinder

A: REMOVAL

1) Disconnect the ground cable from battery. <Ref. to NT-5, BATTERY, NOTE, Note.>

NOTE:

For models other than STI model, disconnect the ground terminal from battery sensor.

2) Thoroughly drain the clutch fluid from the reservoir tank.

3) Remove the instrument panel lower cover. <Ref. to EI-61, REMOVAL, Instrument Panel Lower Cover.>

4) Remove the snap pin and clevis pin, and then separate the push rod of the master cylinder from clutch pedal.

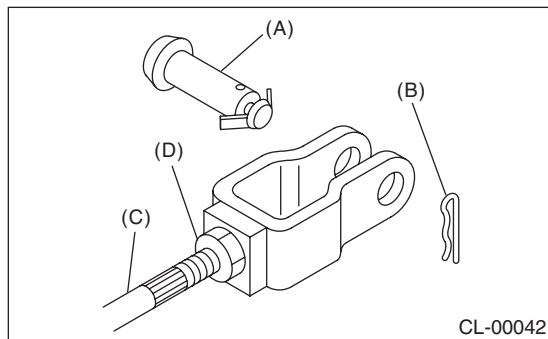

- (A) Clevis pin
- (B) Snap pin
- (C) Push rod
- (D) Lock nut

5) Remove the intercooler. <Ref. to IN(STI)-13, REMOVAL, Intercooler.> <Ref. to IN(w/o STI)-38, REMOVAL, Intercooler.>

6) Disconnect the clutch pipe and reservoir hose from the master cylinder.

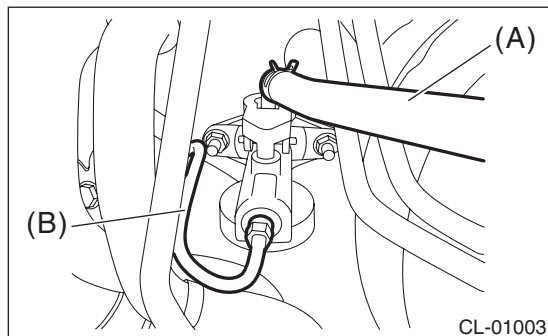

- (A) Reservoir hose
- (B) Clutch pipe

7) Remove the clutch bracket from the bulkhead.

8) Remove the master cylinder.

CAUTION:

Be careful not to spill the brake fluid. Brake fluid spilled on the vehicle body will harm the paint surface; wash it off with water and wipe clean quickly if spilled.

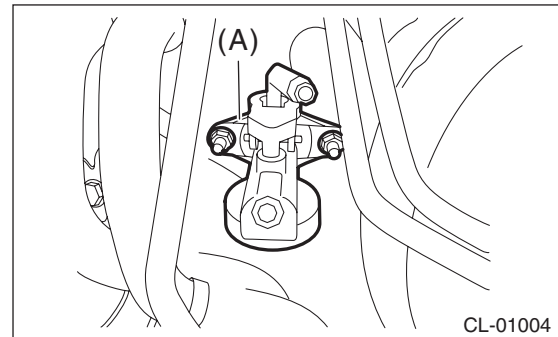

- (A) Master cylinder

B: INSTALLATION

1) Attach the clutch bracket to the bulkhead.

Tightening torque:

25 N·m (2.5 kgf-m, 18.4 ft-lb)

2) Install the master cylinder to the vehicle body, and connect the clutch pipe and reservoir hose to the master cylinder.

Tightening torque:

T1: 15 N·m (1.5 kgf-m, 11.1 ft-lb)

T2: 18 N·m (1.8 kgf-m, 13.3 ft-lb)

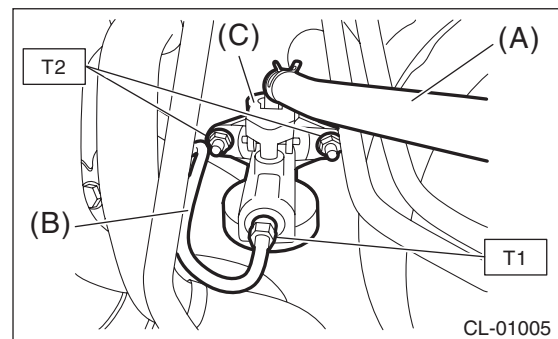

- (A) Reservoir hose
- (B) Clutch pipe
- (C) Master cylinder

3) Connect the push rod of the master cylinder to the clutch pedal, and install the clevis pin and snap pin.

CAUTION:

Always use a new clevis pin.

NOTE:

Apply grease to the clevis pin.

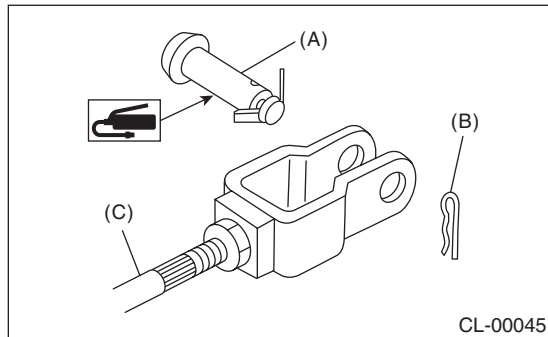

- (A) Clevis pin
- (B) Snap pin
- (C) Push rod

4) Refill the reservoir tank with recommended clutch fluid.

5) After bleeding air from the clutch system, ensure that the clutch operates properly.

<Ref. to CL-29, Clutch Fluid Air Bleeding.>

6) Install the intercooler. <Ref. to IN(STI)-14, INSTALLATION, Intercooler.> <Ref. to IN(w/o STI)-41, INSTALLATION, Intercooler.>

7) Connect the battery ground terminal. <Ref. to NT-5, BATTERY, NOTE, Note.>

NOTE:

For models other than STI model, connect the ground terminal to battery sensor.

C: DISASSEMBLY

1) Remove the straight pin and nipple.

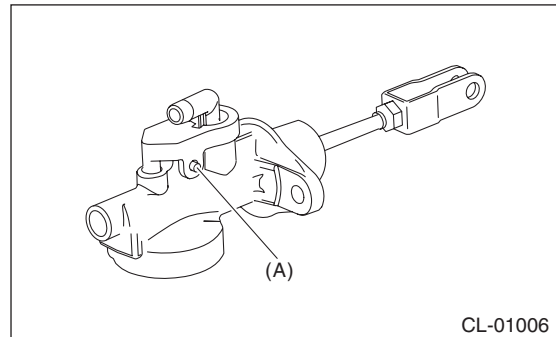

- (A) Straight pin

2) Remove the oil seal.

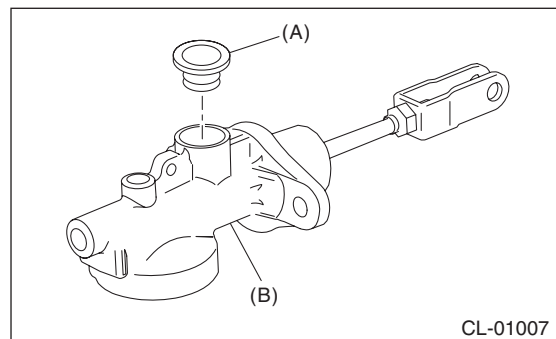

- (A) Oil seal
- (B) Master cylinder

3) Move the seat towards the rear.

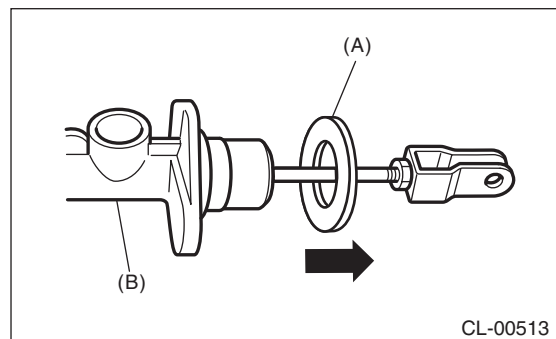

- (A) Seat
- (B) Master cylinder

4) Remove the piston stop ring.

CAUTION:

When removing the piston stop ring, be careful to prevent the rod, washer, piston and return spring from popping out.

Master Cylinder

CLUTCH SYSTEM

D: ASSEMBLY

1) Apply a coat of grease to the contact surfaces of the push rod and piston before installation.

Grease:

SILICONE GREASE G-40M or equivalent

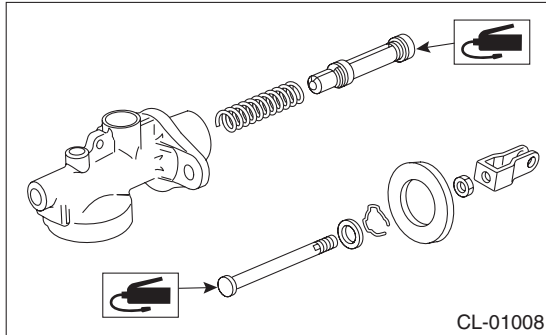

2) Assemble in the reverse order of disassembly.

Tightening torque:

10 N·m (1.0 kgf·m, 7.4 ft·lb)

E: INSPECTION

If any damage, deformation, wear, swelling, rust or other faults are found on the cylinder, piston, push rod, reservoir tank, return spring, breather screw, seat or hose, replace the faulty part.

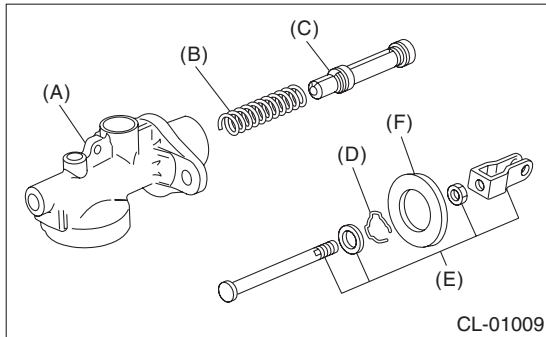

- (A) Master cylinder body
- (B) Return spring
- (C) Piston
- (D) Piston stop ring
- (E) Push rod ASSY
- (F) Seat